

CHECK VALVES

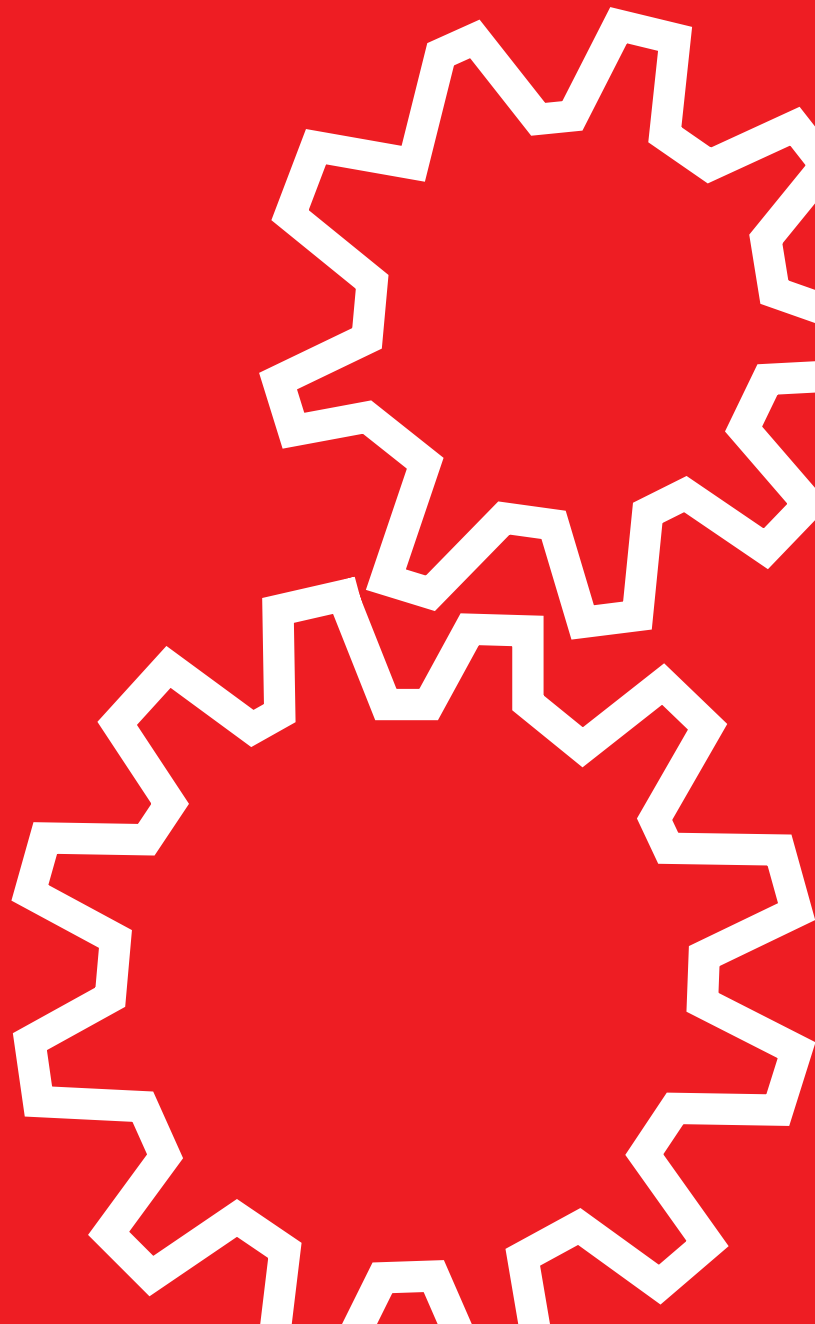
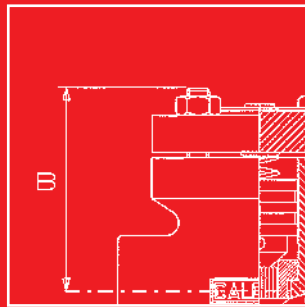
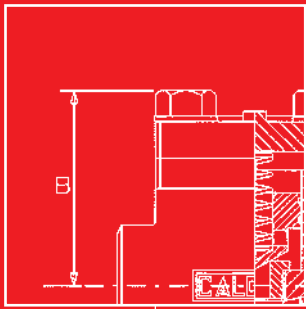

Check valves are uni-directional valves which automatically open with forward flow and close against reverse flow. They are supplied to meet a wide variety of applications with the closing element in the piston, ball or swing type. Piston check valves are normally supplied by CALOBRI with the addition of a spring which allows both the vertical and horizontal installation.

Great care is given by CALOBRI employees in the design and in manufacturing to prevent noisy operation and unsatisfactory wear of closure components.

CLASS	DESIGN	CONNECTION	PORT	STANDARD	Screw & Yoke	ENDS	CALOBRI
800	Piston	Bolted bonnet	Reduced	BS5352	Outside	Threaded and Socket Weld Ends	P8
800	Piston	Bolted bonnet	Full	BS5352	Outside	Threaded and Socket Weld Ends	P88
800	Ball	Bolted bonnet	Reduced	BS5352	Outside	Threaded and Socket Weld Ends	C8
800	Ball	Bolted bonnet	Full	BS5352	Outside	Threaded and Socket Weld Ends	C88
800	Swing	Bolted bonnet	Reduced	BS5352	Outside	Threaded and Socket Weld Ends	B8
800	Swing	Bolted bonnet	Full	BS5352	Outside	Threaded and Socket Weld Ends	B88
800	Piston	Welded Bonnet	Reduced	BS5352	Outside	Threaded and Socket Weld Ends	WP8
800	Piston	Welded Bonnet	Full	BS5352	Outside	Threaded and Socket Weld Ends	WP88
800	Ball	Welded Bonnet	Reduced	BS5352	Outside	Threaded and Socket Weld Ends	WC8
800	Ball	Welded Bonnet	Full	BS5352	Outside	Threaded and Socket Weld Ends	WC88
800	Swing	Welded Bonnet	Reduced	BS5352	Outside	Threaded and Socket Weld Ends	WB8
800	Swing	Welded Bonnet	Full	BS5352	Outside	Threaded and Socket Weld Ends	WB88
1500	Piston	Bolted bonnet	Reduced	BS5352	Outside	Threaded and Socket Weld Ends	P15
1500	Piston	Bolted bonnet	Full	BS5352	Outside	Threaded and Socket Weld Ends	P1515
1500	Ball	Bolted bonnet	Reduced	BS5352	Outside	Threaded and Socket Weld Ends	C15
1500	Ball	Bolted bonnet	Full	BS5352	Outside	Threaded and Socket Weld Ends	C1515
1500	Swing	Bolted bonnet	Reduced	BS5352	Outside	Threaded and Socket Weld Ends	B15
1500	Swing	Bolted bonnet	Full	BS5352	Outside	Threaded and Socket Weld Ends	B1515
1500	Piston	Welded Bonnet	Reduced	BS5352	Outside	Threaded and Socket Weld Ends	WP15
1500	Piston	Welded Bonnet	Full	BS5352	Outside	Threaded and Socket Weld Ends	WP1515
1500	Ball	Welded Bonnet	Reduced	BS5352	Outside	Threaded and Socket Weld Ends	WC15
1500	Ball	Welded Bonnet	Full	BS5352	Outside	Threaded and Socket Weld Ends	WC1515
1500	Swing	Welded Bonnet	Reduced	BS5352	Outside	Threaded and Socket Weld Ends	WB15
1500	Swing	Welded Bonnet	Full	BS5352	Outside	Threaded and Socket Weld Ends	WB1515
1500	Piston	Ring Joint BB	Full	ANSI B16.34	Outside	Threaded and Socket Weld Ends	RJ-P1515
1500	Ball	Ring Joint BB	Full	ANSI B16.34	Outside	Threaded and Socket Weld Ends	RJ-C1515
1500	Swing	Ring Joint BB	Full	ANSI B16.34	Outside	Threaded and Socket Weld Ends	RJ-B1515
2500	Piston	Ring Joint BB	Full	ANSI B16.34	Outside	Threaded and Socket Weld Ends	RJ-P25
2500	Ball	Ring Joint BB	Full	ANSI B16.34	Outside	Threaded and Socket Weld Ends	RJ-C25
2500	Piston	Welded Bonnet	Full	ANSI B16.34	Outside	Threaded and Socket Weld Ends	WP25
2500	Ball	Welded Bonnet	Full	ANSI B16.34	Outside	Threaded and Socket Weld Ends	WC25
4500	Piston	Welded Bonnet	Full	ANSI B16.34	Outside	Threaded and Socket Weld Ends	WP45
4500	Ball	Welded Bonnet	Full	ANSI B16.34	Outside	Threaded and Socket Weld Ends	WC45
800	Piston Y Pattern	Welded Bonnet	Full	BS5352	Outside	Threaded and Socket Weld Ends	YP88
1500	Piston Y Pattern	Welded Bonnet	Full	ANSI B16.34	Outside	Threaded and Socket Weld Ends	YP1515
2500	Piston Y Pattern	Welded Bonnet	Full	ANSI B16.34	Outside	Threaded and Socket Weld Ends	YP25
4500	Piston	Welded Bonnet	Full	ANSI B16.34	Outside	Threaded and Socket Weld Ends	YP45

Class 800 and 1500

Bolted Bonnet - Full and Reduced Bore

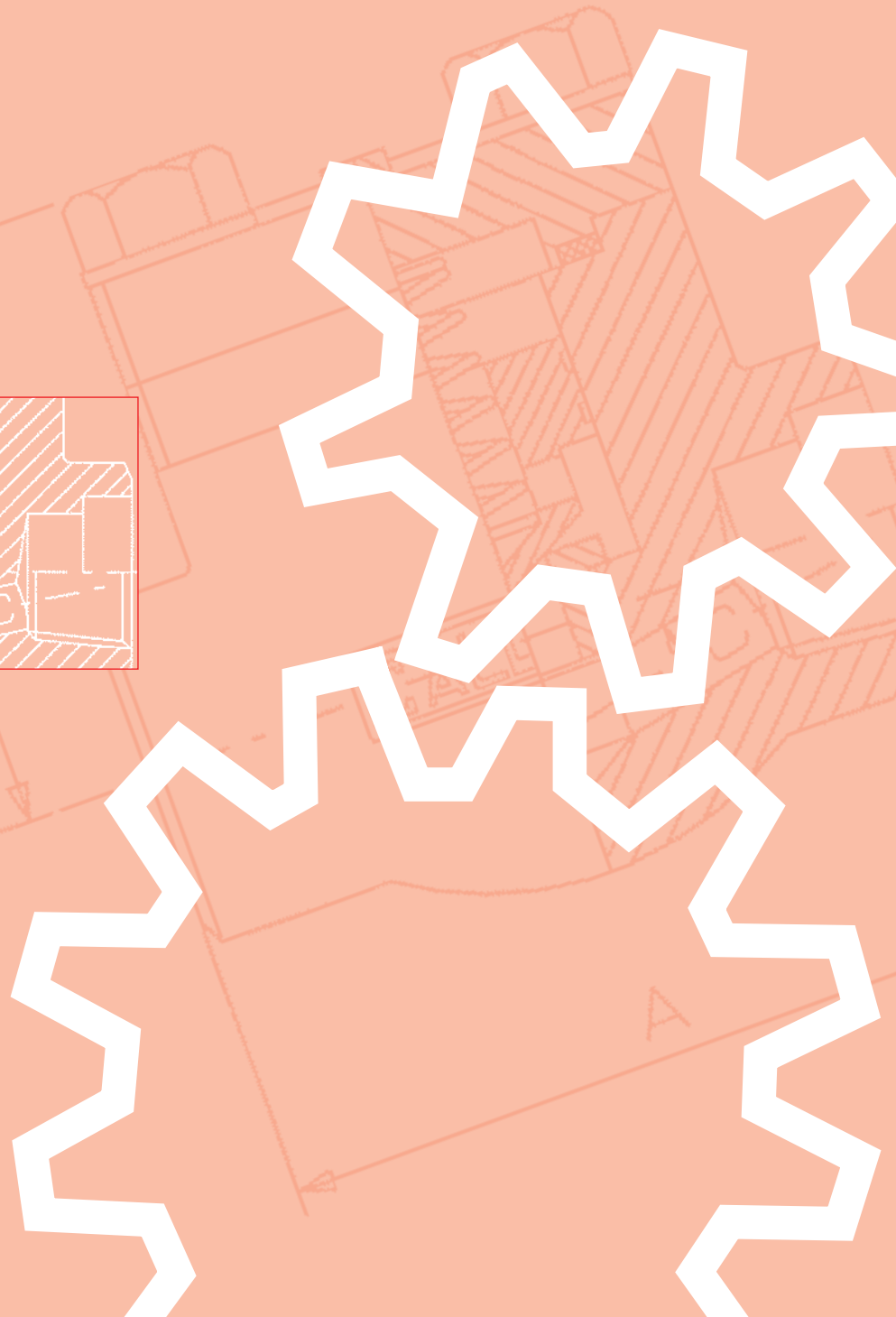
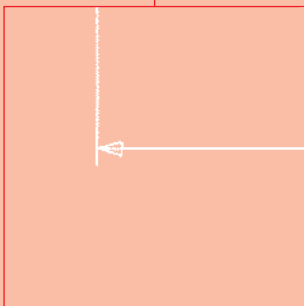
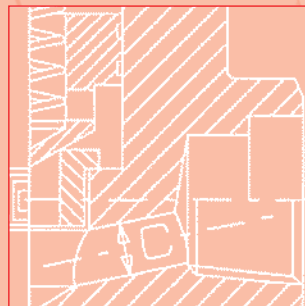
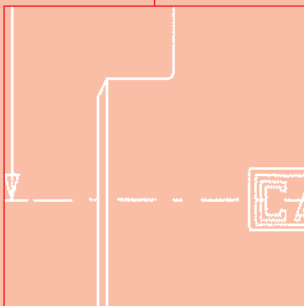
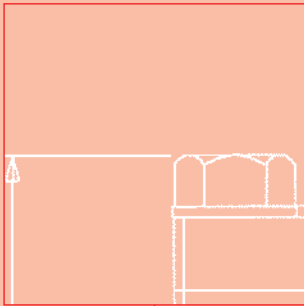

Design & Construction:
BS 5352
Testing according to API 598 - BS 6755
Marking MSS SP25

Spiral-wound gasket retained type
- carbon steel class 800 1975 psig @ 100° F
138 bar + 38° C
- carbon steel class 1500 3705 psig @ 100° F
255 bar + 38° C

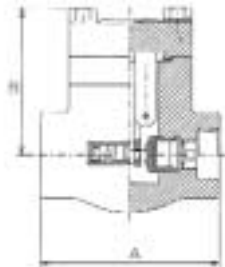
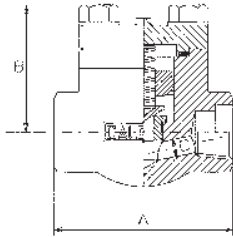

CLASS 800

FULL BORE									
SIZE	inch	1/4	3/8	1/2	3/4	1	1.1/4	1.1/2	2
	mm	6	10	15	20	25	32	40	50
A	Piston - Ball	inch 3.14	inch 3.14	inch 3.54	inch 4.33	inch 5.00	inch 6.10	inch 6.69	inch 8.26
	mm	80	80	90	110	127	155	170	210
B	Swing	inch 3.14	inch 3.14	inch 3.54	inch 4.33	inch 5.00	inch 5.00	inch 5.00	inch 8.26
	mm	80	80	90	110	127	127	127	210
C	Piston - Ball	inch 0.28	inch 0.35	inch 0.51	inch 0.69	inch 0.88	inch 1.16	inch 1.38	inch 1.79
	mm	7	9	13	17.5	22.5	29.5	35	45.5
Weight	Piston - Ball	Lb 2.8	Lb 2.8	Lb 3.0	Lb 5.2	Lb 8.8	Lb 16.2	Lb 17.6	Lb 39.6
	kg	1.3	1.3	1.4	2.4	4.0	7.4	8	18
FIGURE	Piston	P88							
	Ball	C88							
GASKET	Swing	B88							
		40x30	40x30	40x30	48x38	54x44	66x54	74x60	95x78

REDUCED BORE							
SIZE	inch	1/2	3/4	1	1.1/4	1.1/2	2
	mm	15	20	25	32	40	50
A	Piston - Ball	inch 3.14	inch 3.54	inch 4.33	inch 5.00	inch 6.10	inch 6.69
	mm	80	90	110	127	155	170
B	Swing	inch 3.14	inch 3.54	inch 4.33	inch 5.00	inch 5.00	inch 5.00
	mm	80	90	110	127	127	127
C	Piston - Ball	inch 0.35	inch 0.51	inch 0.69	inch 0.88	inch 1.16	inch 1.38
	mm	9	13	17.5	22.5	29.5	35
Weight	Piston - Ball	Lb 2.8	Lb 3.0	Lb 5.2	Lb 8.8	Lb 16.2	Lb 17.6
	kg	1.3	1.4	2.4	4.0	7.4	8
FIGURE	Piston	P8					
	Ball	C8					
GASKET	Swing	B8					
		40x30	40x30	48x38	54x44	66x54	74x60

CLASS 1500

FULL BORE									
SIZE	inch	1/4	3/8	1/2	3/4	1	1.1/4	1.1/2	2
	mm	6	10	15	20	25	32	40	50
A	Piston - Ball	inch 3.54	inch 3.54	inch 4.33	inch 5.00	inch 6.10	inch 6.69	inch 8.26	inch 8.26
	mm	90	90	110	127	155	170	210	210
B	Swing	inch 3.54	inch 3.54	inch 4.33	inch 5.00	inch 5.00	inch 5.00	inch 8.26	inch 8.26
	mm	90	90	110	127	127	127	210	210
C	Piston - Ball	inch 0.28	inch 0.35	inch 0.51	inch 0.69	inch 0.83	inch 1.10	inch 1.30	inch 1.48
	mm	7	9	13	17.5	21	28	33	37.5
Weight	Piston - Ball	Lb 3.3	Lb 3.3	Lb 6.1	Lb 10.1	Lb 16.2	Lb 19.8	Lb 49.9	Lb 41.8
	kg	1.5	1.5	2.8	4.6	7.4	9	19.5	19
FIGURE	Piston	P1515							
	Ball	C1515							
GASKET	Swing	B1515							
		40x30	40x30	40x30	48x38	54x44	66x54	74x60	74x60

REDUCED BORE							
SIZE	inch	1/2	3/4	1	1.1/4	1.1/2	2
	mm	15	20	25	32	40	50
A	Piston - Ball	inch 3.54	inch 4.33	inch 5.00	inch 6.10	inch 6.69	inch 8.26
	mm	90	110	127	155	170	210
B	Swing	inch 3.54	inch 4.33	inch 5.00	inch 5.00	inch 5.00	inch 8.26
	mm	90	110	127	127	127	210
C	Piston - Ball	inch 0.35	inch 0.51	inch 0.69	inch 0.83	inch 1.10	inch 1.30
	mm	9	13	17.5	21	28	33
Weight	Piston - Ball	Lb 3.3	Lb 6.1	Lb 10.1	Lb 16.2	Lb 19.8	Lb 49.9
	kg	1.5	2.8	4.6	7.4	9	19.5
FIGURE	Piston	P15					
	Ball	C15					
GASKET	Swing	B15					
		40x30	40x30	48x38	54x44	66x54	74x60

Class 1500 and 2500 **Bolted Bonnet - Full Bore**

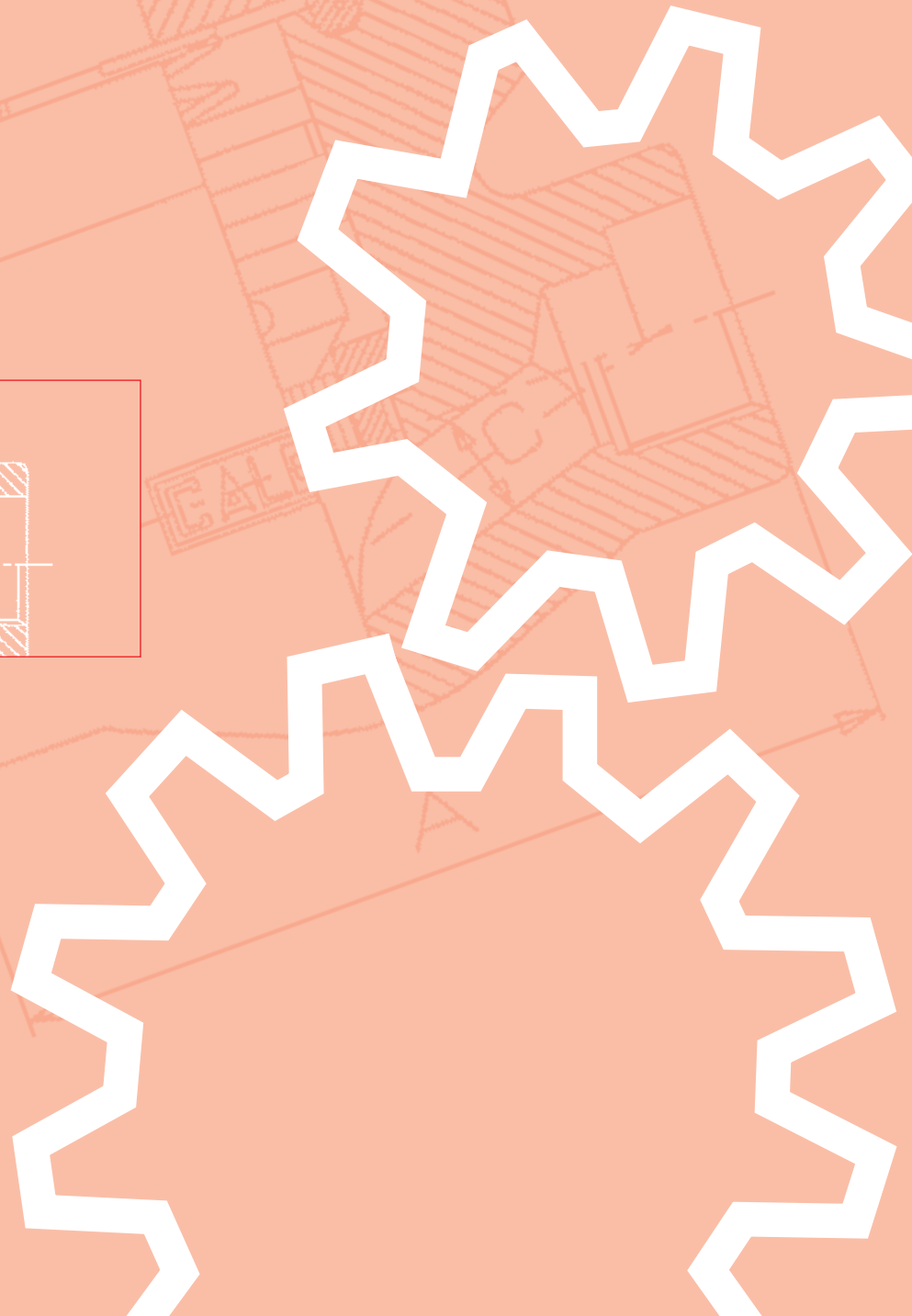
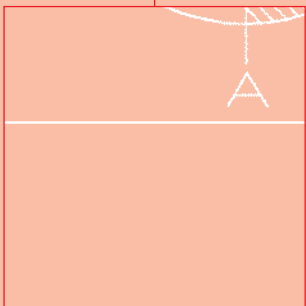
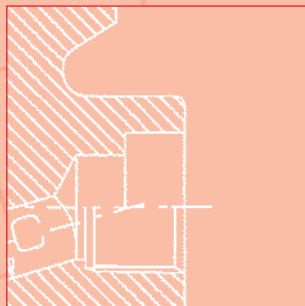
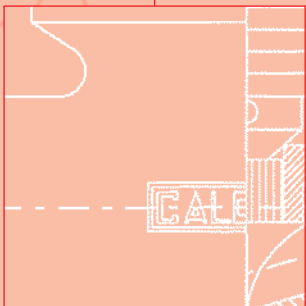
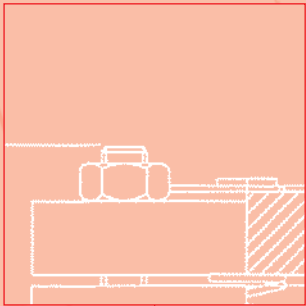

Design construction:

BS 5352

ASME B16.34

Testing according to API 598 - BS 6755

Marking MSS SP25

Ratings:

- carbon steel class 1500 3705 psig @ 100° F
255 bar + 38° C

- carbon steel class 2500 6170 psig @ 100° F
425 bar + 38° C

Socket weld Ends to ANSI B16.11

Screwed Ends (NPT) to ANSI B1.20.1

Butt Welding Ends to ANSI B.16.25

Ring - Joint Gasket to ASME B16.20 - API 6A

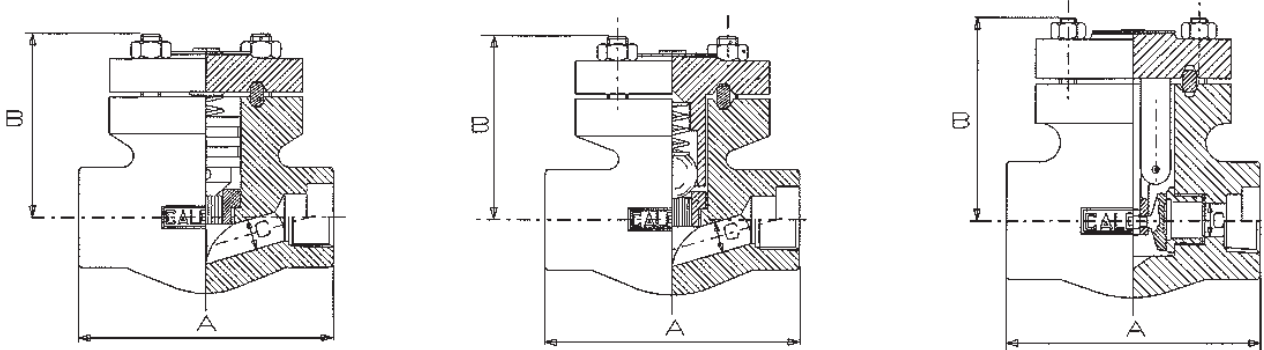

CLASS 1500

FULL BORE										
SIZE	inch	1/4	3/8	1/2	3/4	1	1.1/4	1.1/2	2	
	mm	6	10	15	20	25	32	40	50	
A	inch	-	-	4.33	5.90	5.90	-	8.26	9.25	
	mm	-	-	110	150	150	-	210	235	
B	inch	-	-	3.93	5.11	5.70	-	6.29	7.67	
	mm	-	-	100	130	145	-	160	195	
C	Piston - Ball	inch	-	0.51	0.67	0.83	-	1.30	1.48	
		mm	-	13	17	21	-	33	37.5	
Swing	inch	-	-	0.55	0.70	0.94	-	1.45	1.89	
	mm	-	-	14	18	24	-	37	48	
Weight	Piston - Ball	Lb	-	8.8	16.5	19.8	-	40.7	66	
		Kg	-	4	7.5	9	-	18.5	30	
	Swing	lb	-	8.37	15.4	18.7	-	38.5	63.8	
		kg	-	3.8	7	8.5	-	17.5	29	
FIGURE	Piston	RJP1515								
	Ball	RJC1515								
	Swing	RJB1515								
RING JOINT		-	-	RJ-13	RJ-16	RJ-17	-	RJ-21	RJ-23	

CLASS 2500

FULL BORE										
SIZE	inch	1/4	3/8	1/2	3/4	1	1.1/4	1.1/2	2	
	mm	6	10	15	20	25	32	40	50	
A	inch	-	-	5.90	5.90	8.26	-	9.25	9.25	
	mm	-	-	150	150	210	-	235	235	
B	inch	-	-	5.11	5.11	6.29	-	7.67	7.67	
	mm	-	-	130	130	160	-	195	195	
C	inch	-	-	0.51	0.67	0.83	-	1.30	1.37	
	mm	-	-	13	17	21	-	33	35	
Weight	Lb	-	-	15.4	14.9	38.5	-	63.8	63.8	
		Kg	-	-	7	6.8	17.5	-	29	29
FIGURE	Piston	RJP25								
	Ball	RJC25								
	RING JOINT		-	-	RJ-16	RJ-16	RJ-17	-	RJ-21	RJ-21

Class 800 and 1500

Welded Bonnet - Full and Reduced Bore

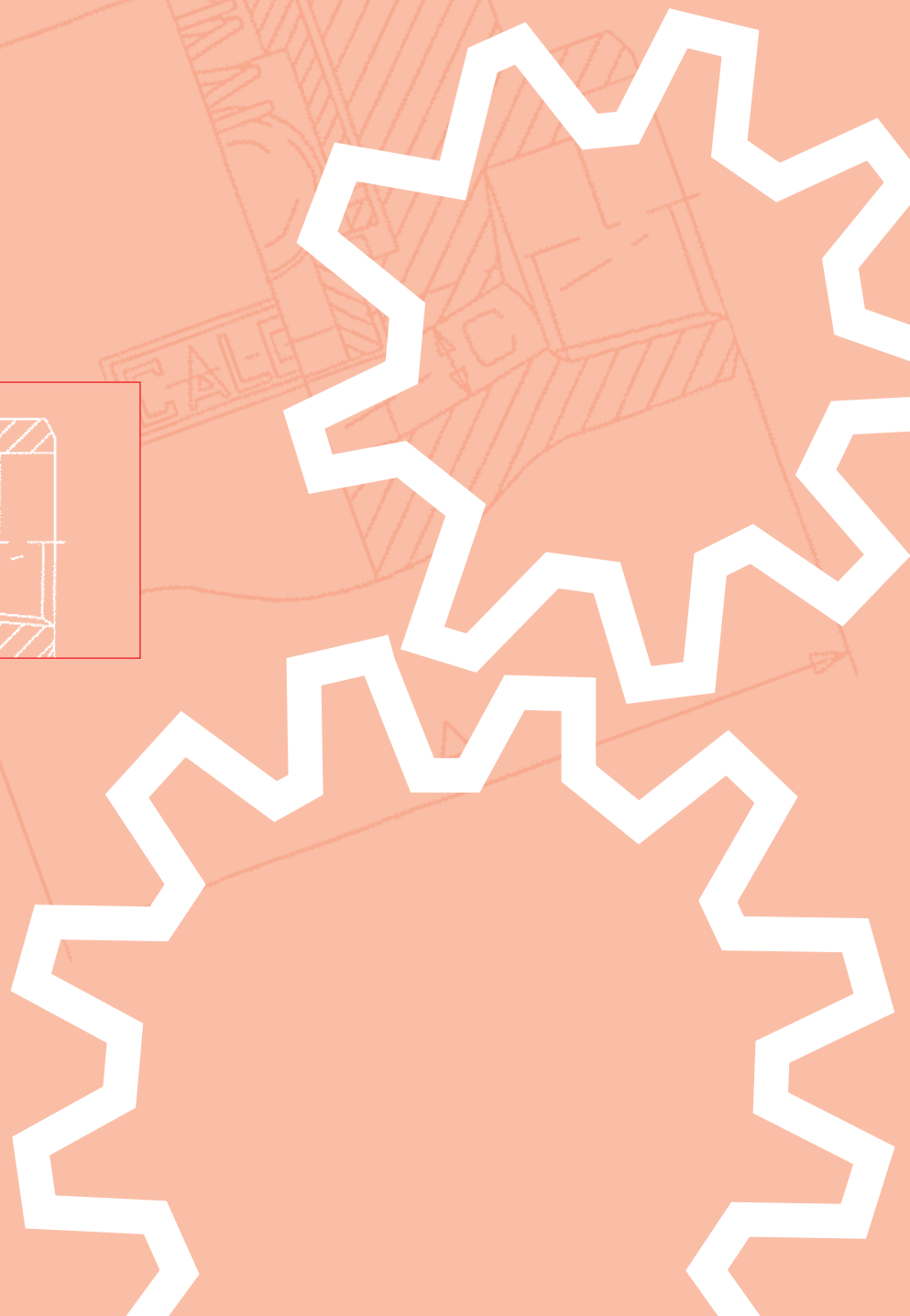
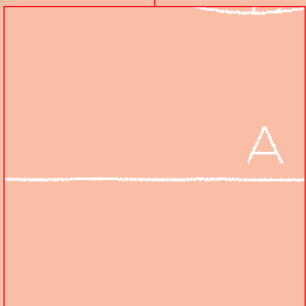
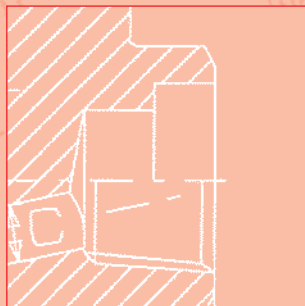
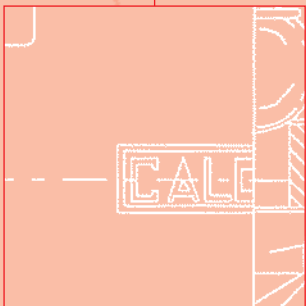
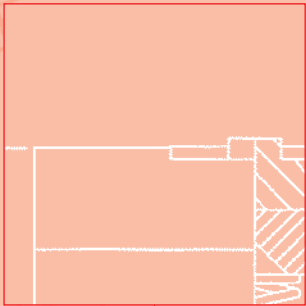

Design & Construction:
 BS 5352
 Testing according to API 598 - BS 6755
 Marking MSS SP25

Socket weld Ends to ANSI B16.11
 Screwed Ends (NPT) to ANSIB1.20.1
 Butt Welding Ends to ANSI B.16.25

Ratings:
 - carbon steel class 800 1975 psig @ 100° F
 138 bar + 38° C
 - carbon steel class 1500 3705 psig @ 100° F
 255 bar + 38° C

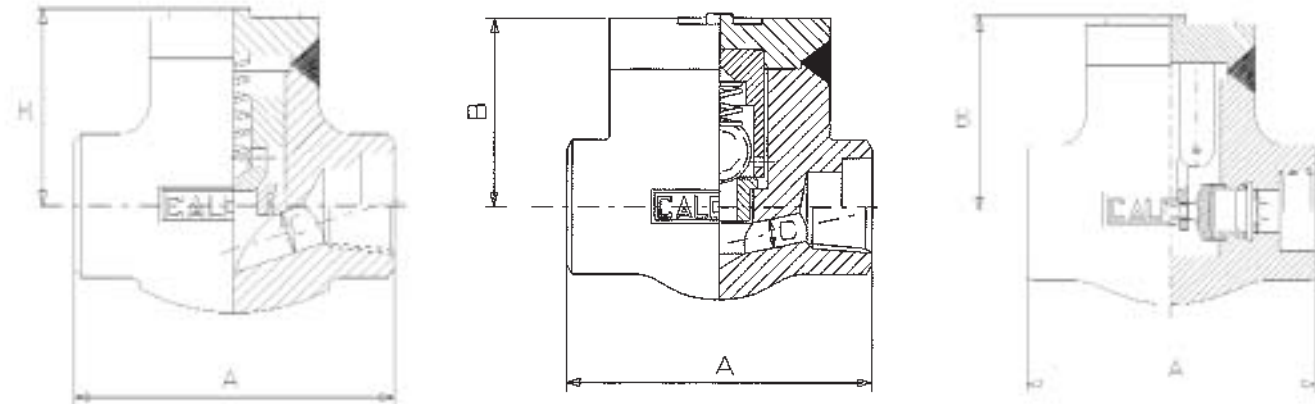

CLASS 800

FULL BORE									
SIZE	inch	1/4	3/8	1/2	3/4	1	1.1/4	1.1/2	2
	mm	6	10	15	20	25	32	40	50
A	inch	3.14	3.14	3.54	4.33	5.00	6.10	6.69	8.26
	mm	80	80	90	110	127	155	170	210
B	inch	2.08	2.08	2.36	2.87	3.14	3.85	4.33	5.90
	mm	53	53	60	73	80	98	110	150
C	inch	0.28	0.35	0.51	0.69	0.88	1.16	1.37	1.79
	mm	7	9	13	17.5	22.5	29.5	35	45.5
Weight	Lb	2.8	2.8	3.0	5.2	8.8	16.3	17.6	37.4
	Kg	1.3	1.3	1.4	2.4	4.0	7.4	8	17
FIGURE	Piston	WP88							
	Ball	WC88							
Swing		WB88	WB88	WB88	WB88	WB88	WB88	WB88	WB88

REDUCED BORE							
SIZE	inch	1/2	3/4	1	1.1/4	1.1/2	2
	mm	15	20	25	32	40	50
A	inch	3.14	3.54	4.33	5.00	6.10	6.69
	mm	80	90	110	127	155	170
B	inch	2.08	2.36	2.87	3.14	3.85	4.33
	mm	53	60	73	80	98	110
C	inch	0.35	0.51	0.69	0.88	1.16	1.37
	mm	9	13	17.5	22.5	29.5	35
Weight	Lb	2.8	3.0	5.2	8.8	16.3	17.6
	Kg	1.3	1.4	2.4	4.0	7.4	8
FIGURE	Piston	WP8					
	Ball	WC8					
Swing		WB8	WB8	WB8	WB8	WB8	WB8

CLASS 1500

FULL BORE									
SIZE	inch	1/4	3/8	1/2	3/4	1	1.1/4	1.1/2	2
	mm	6	10	15	20	25	32	40	50
A	inch	3.54	3.54	4.33	5.00	6.10	6.69	8.26	8.26
	mm	90	90	110	127	155	170	210	210
B	inch	2.36	2.36	2.87	3.14	3.85	4.33	5.90	5.90
	mm	60	60	73	80	98	110	150	150
C	inch	0.28	0.35	0.51	0.67	0.83	1.10	1.30	1.47
	mm	7	9	13	17	21	28	33	37.5
Weight	Lb	3.3	3.3	6.1	10.1	16.3	19.8	33.0	31.9
	Kg	1.5	1.5	2.8	4.6	7.4	9	15	14.5
FIGURE	Piston	WP1515							
	Ball	WC1515							
Swing		WB1515	WB1515	WB1515	WB1515	WB1515	WB1515	WB1515	WB1515

REDUCED BORE							
SIZE	inch	1/2	3/4	1	1.1/4	1.1/2	2
	mm	15	20	25	32	40	50
A	inch	3.54	4.33	5.00	6.10	6.69	8.26
	mm	90	110	127	155	170	210
B	inch	2.36	2.87	3.14	3.85	4.33	5.90
	mm	60	73	80	98	110	150
C	inch	0.35	0.51	0.67	0.83	1.10	1.30
	mm	9	13	17	21	28	33
Weight	Lb	3.3	6.1	10.1	16.3	19.8	33.0
	Kg	1.5	2.8	4.6	7.4	9	15
FIGURE	Piston	WP15					
	Ball	WC15					
Swing		WB15	WB15	WB15	WB15	WB15	WB15

Class 2500 and 4500 **Welded Bonnet - Full Bore**

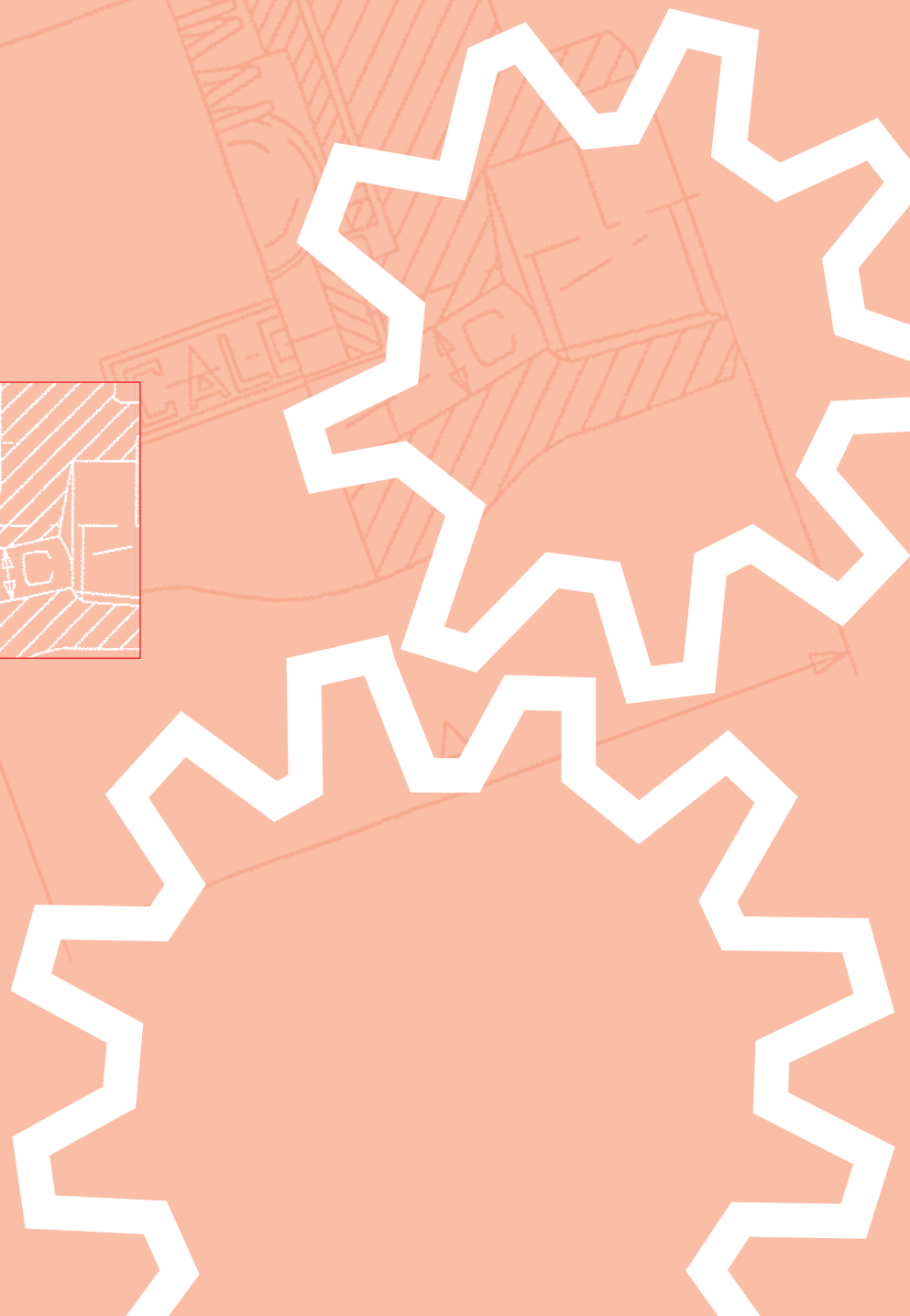
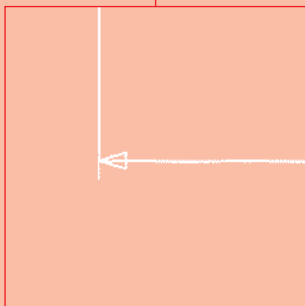
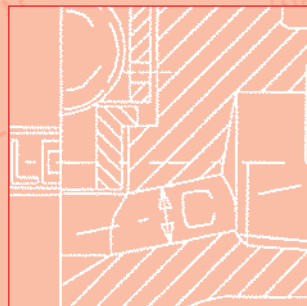
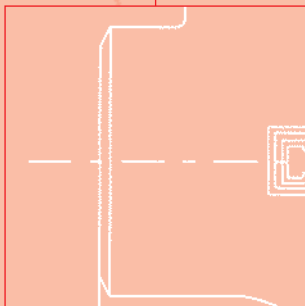
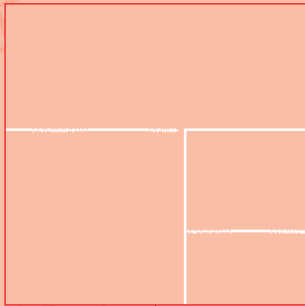

Design & Construction:
 ASME B16.34
 Testing according to API 598 - BS 6755
 Marking MSS SP25

Ratings:
 - carbon steel class 2500 6170 psig @ 100° F
 425 bar + 38° C
 - carbon steel class 4500 11110 psig @ 100° F
 765 bar + 38° C

Socket weld Ends to ANSI B16.11
 Screwed Ends (NPT) to ANSI B1.20.1
 Butt Welding Ends to ANSI B.16.25

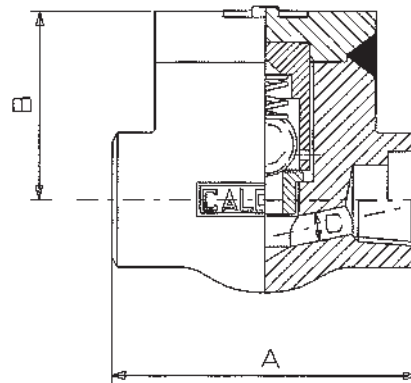
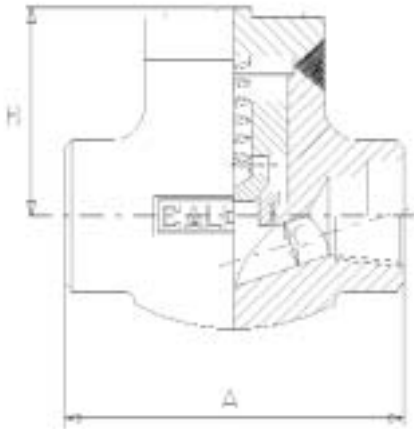

CLASS 2500

FULL BORE									
SIZE	inch mm	1/4 6	3/8 10	1/2 15	3/4 20	1 25	1.1/4 32	1.1/2 40	2 50
A	inch mm	-	-	5.00 127	6.10 155	6.69 170	-	9.25 235	9.25 235
B	inch mm	-	-	3.14 80	3.85 98	4.33 110	-	6.69 170	6.69 170
C	inch mm	-	-	0.51 13	0.67 17	0.83 21	-	1.30 33	1.37 35
Weight	Lb Kg	-	-	11.0 5	17.6 8	22.0 10	-	47.3 21.5	46.9 21.3
FIGURE	Piston	WP25							
	Ball	WC25							
Swing		-	-	WB25	WB25	WB25	-	WB25	WB25

CLASS 4500

FULL BORE									
SIZE	inch mm	1/4 6	3/8 10	1/2 15	3/4 20	1 25	1.1/4 32	1.1/2 40	2 50
A	inch mm	-	-	8.26 210	8.26 210	9.25 235	-	9.25 235	-
B	inch mm	-	-	6.29 160	6.29 160	7.67 195	-	7.67 195	-
C	inch mm	-	-	0.35 9	0.43 11	0.55 14	-	1.10 28	-
Weight	Lb Kg	-	-	39.6 18	39.6 18	65.0 29.5	-	65.0 29.5	-
FIGURE	Piston	WP45							
	Ball	WC45							
Swing		-	-	WB45	WB45	WB45	-	WB45	-

Class 800 - 1500 - 2500 - 4500
Welded Bonnet - Full Bore (Y type)

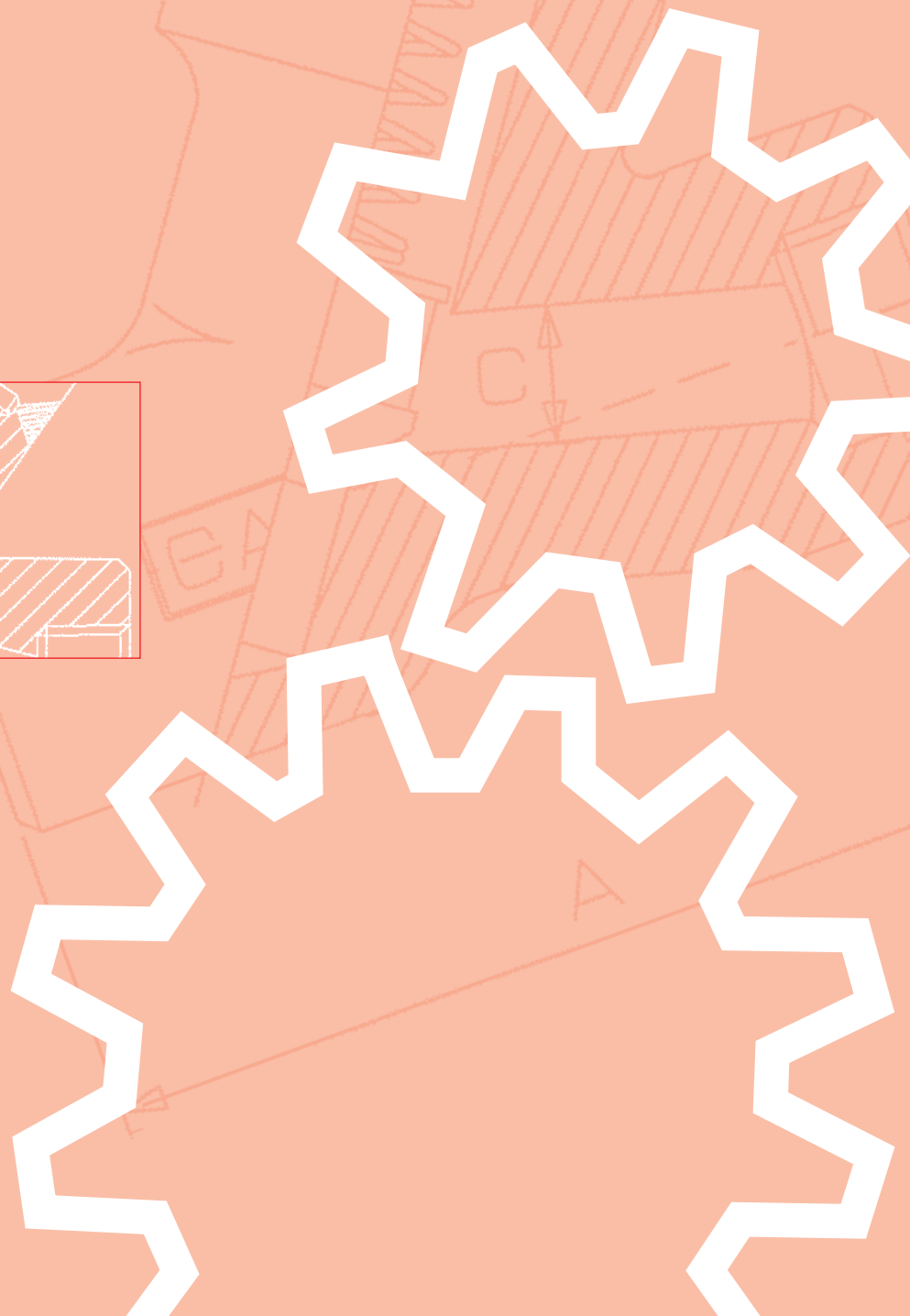
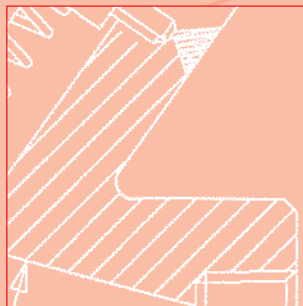
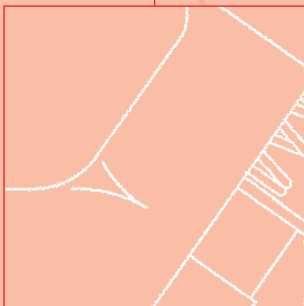
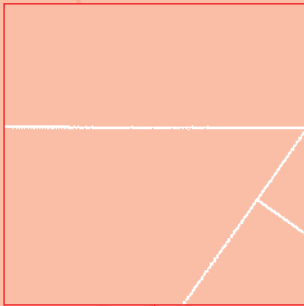

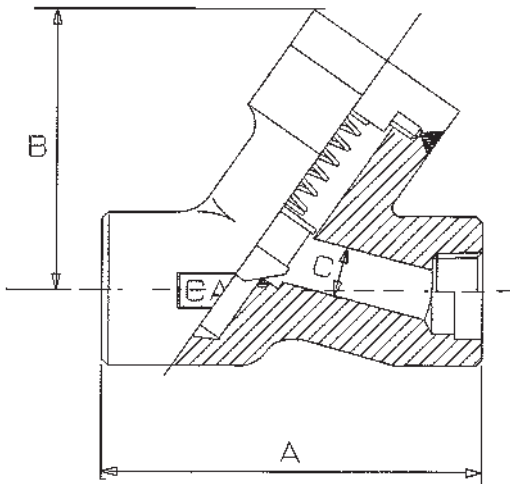

Design & Construction:
 BS 5352 - ASME B16.34
 Testing according to API 598 - BS 6755
 Marking MSS SP25

Socket weld Ends to ANSI B16.11
 Screwed Ends (NPT) to ANSI B1.20.1
 Butt Welding Ends to ANSI B.16.25

- Ratings:
- carbon steel class 800 1975 psig @ 100° F
138 bar + 38° C
 - carbon steel class 1500 3705 psig @ 100° F
255 bar + 38° C
 - carbon steel class 2500 6170 psig @ 100° F
425 bar + 38° C
 - carbon steel class 4500 11110 psig @ 100° F
765 bar + 38° C

CLASS 800

FULL BORE

SIZE	inch	1/4	3/8	1/2	3/4	1	1.1/4	1.1/2	2
	mm	6	10	15	20	25	32	40	50
A	inch	3.54	3.54	3.54	3.54	5.00	5.00	6.10	7.08
	mm	90	90	90	90	127	127	155	180
B	inch	2.55	2.55	2.55	2.55	3.14	3.74	4.52	5.31
	mm	65	65	65	65	80	95	115	135
C	inch	0.27	0.35	0.51	0.68	0.88	1.16	1.37	1.79
	mm	7	9	13	17.5	22.5	29.5	35	45.5
WEIGHT	lb	2.6	2.6	2.6	3.9	6.6	7.2	12.7	15.4
	kg	1.2	1.2	1.2	1.2	3	3.3	5.8	7
FIGURE		YP88							

CLASS 2500-2700

FULL BORE

SIZE	inch	1/4	3/8	1/2	3/4	1	1.1/4	1.1/2	2
	mm	6	10	15	20	25	32	40	50
A	inch	5.00	5.00	5.00	5.00	6.10	6.10	7.08	8.86
	mm	127	127	127	127	155	155	180	225
B	inch	4.52	4.52	4.52	4.72	5.90	5.90	6.30	6.70
	mm	115	115	115	120	150	150	160	170
C	inch	0.27	0.35	0.43	0.59	0.76	1.08	1.24	1.53
	mm	7	9	11	15	19.5	27.5	31.5	39
WEIGHT	lb	7.0	7.0	7.7	7.7	13.7	12.3	22.9	30.8
	kg	3.2	3.2	3.5	3.5	6.2	5.6	10.4	14
FIGURE		YP25							

CLASS 1500-1700

FULL BORE

SIZE	inch	1/4	3/8	1/2	3/4	1	1.1/4	1.1/2	2
	mm	6	10	15	20	25	32	40	50
A	inch	3.54	3.54	3.54	5.00	5.00	6.10	6.10	7.08
	mm	90	90	90	127	127	155	155	180
B	inch	2.75	2.75	2.75	3.93	3.93	4.72	4.72	5.51
	mm	70	70	70	100	100	120	120	140
C	inch	0.27	0.35	0.43	0.59	0.76	1.08	1.24	1.53
	mm	7	9	11	15	19.5	27.5	31.5	39
WEIGHT	lb	3.3	3.3	3.3	7.0	7.0	13.2	13.6	20.9
	kg	1.5	1.5	1.5	3.2	3.2	6	6.2	9.5
FIGURE		YP1515							

CLASS 4500

FULL BORE

SIZE	inch	1/4	3/8	1/2	3/4	1	1.1/4	1.1/2	2
	mm	6	10	15	20	25	32	40	50
A	inch	6.10	6.10	6.10	6.10	6.10	-	8.86	8.86
	mm	155	155	155	155	155	-	225	225
B	inch	4.72	4.72	4.72	4.72	5.70	-	6.30	6.30
	mm	120	120	120	120	145	-	160	160
C	inch	0.27	0.35	0.43	0.43	0.59	-	1.02	1.10
	mm	7	9	11	11	15	-	26	28
WEIGHT	lb	19.1	19.1	19.1	17.6	16.7	-	36.3	35.2
	kg	8.7	8.7	8.7	8.0	7.6	-	16.5	16
FIGURE		YP45							